

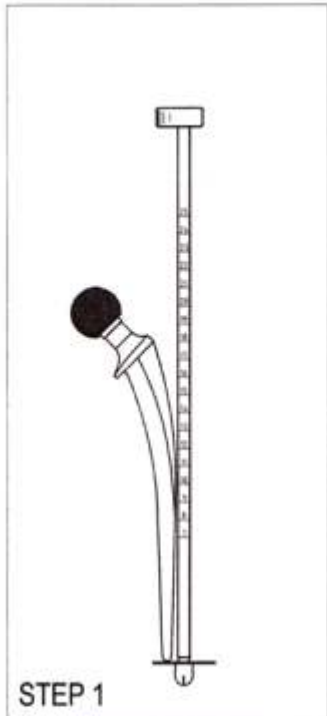

THE UNIVERSAL FEMORAL POLY CEMENT PLUG

SURGICAL TECHNIQUE

REF - ST#025/04



STEP 1

Attach implant to tip of introducer, And measure stem length using the calibrations on the Introducer.

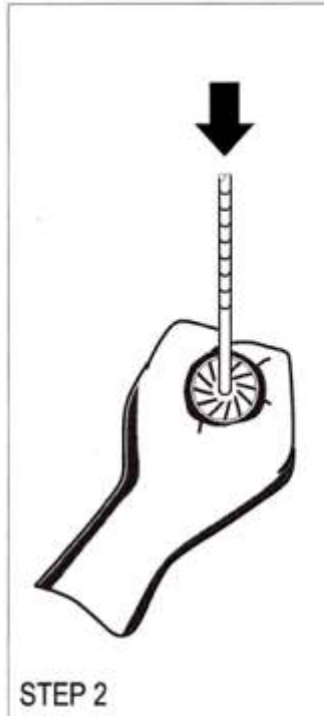

STEP 2

Push implant into the circle formed Between the finger and thumb to 'close up' and form the prosthesis.

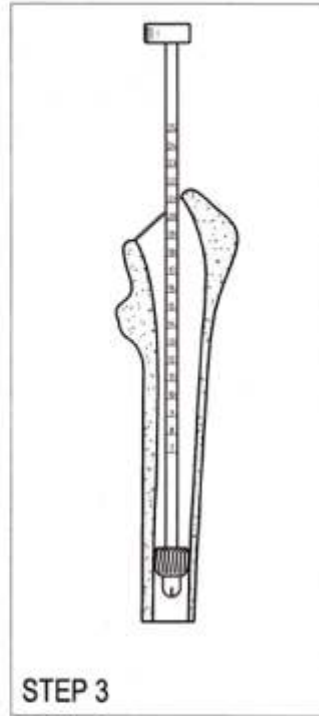

STEP 3

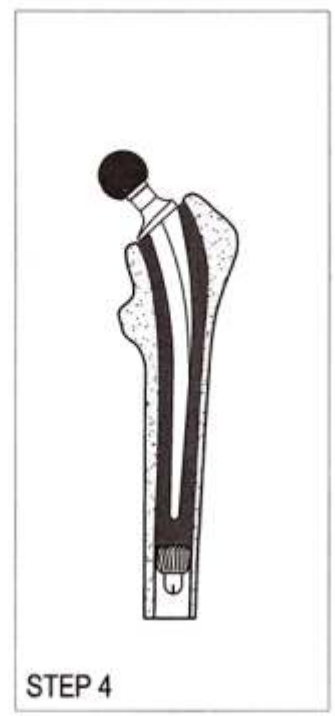

Insert to the required depth, 10mm distal to the tip of the stem. The trial broach / stem can be used to verify the depth.



STEP 4

The canal is filled with cement and the stem is implanted. The radiolucent marker on the tip of the canal plug will facilitate position monitoring of the implant.



| | | |
|---|--|---|
|  | CP 1927 | Universal Femoral Poly Cement Plug - TYPE 1 (12mm-15mm) |
|  | CP 1928 | Universal Femoral Poly Cement Plug - TYPE 2 (15mm-30mm) |
| IN 8914 | Universal Femoral Poly Cement Plug Calibrated Introducer | |

April 10



Manufactured in the UK